



# HF-Selectalume II for TL-D lamps

## HF-S 118/136 TL-D II 220-240V 50/60Hz

HF-Selectalume II TL-D is the most cost-effective, reliable and outstanding solution for fluorescent lamps. These ballasts are part of an overall high-efficiency lighting system that may help you or your customers to achieve any international or local energy code you need to comply with. HF-Selectalume II TL-D ballasts are the ideal choice for a broad range of new construction and retrofit applications within the commercial sector, including general surface mounting or office lighting, parking garages, warehouses, waterproof and other applications. The ballast is primarily designed for Indoor application. For outdoor application, the luminaire should be minimum Classland need to be sufficiently protected against water & dust. The installation should also be guard against any lightening surge or any other necessary electrical protection as deemed in such typical installation & application.

### Product data

| General Information                          |              | Electrical                               |                    |
|--|--------------|--|--------------------|
| Application Code                             | II           | Power Factor 100% Load (Nom)             | 0.98               |
| Type Version                                 | mk1          | Preheat Time                             | 1.6 s              |
| Lamp Type                                    | TL-D         | Mains Voltage Performance (AC)           | 202-254V-8%-+6%    |
| Number of Lamps                              | 1 piece/unit | Mains Voltage Safety (AC)                | 198-264V-10%-+10%  |
| Number of Products on MCB (16A Type B) (Nom) | 28           | Earth Leakage Current (Max)              | 0.5 mA             |
| Automatic Restart                            | Yes          | Inrush Current Width                     | 0.35 ms            |
|  |              | Ballast Factor (Nom)                     | 1.05               |
|  |              | Power Losses (Nom)                       | 3.8 W              |
|  |              | Inrush Current Peak (Max)                | 18 A               |
| Operating and Electrical                     |              | Wiring                                   |                    |
| Input Voltage                                | 220 to 240 V | Connector Type Input Terminals           | WAGO 744 connector |
| Input Frequency                              | 50 to 60 Hz  | Cable Capacity Output Wires Mutual (Max) | 200 pF             |
| Operating Frequency (Nom)                    | 45 kHz       |  |                    |
| Crestfactor (Nom)                            | 1.7          |  |                    |

## HF-Selectalume II for TL-D lamps

|  |  |
|--|--|
| Connector Type Output Terminals                | WAGO 744 connector [ Suitable for manual wiring]                       |
| Cable Length Hot Wiring                        | 0.75 m   |
| Wire Striplength                               | 8.0-9.0 mm   |
| Dual Fixture Master/Slave                      | Possible, lamp wires 2m max. length [ Master/Slave operation possible] |
| Input Terminal Cross Section                   | 0.50-1.50 mm <sup>2</sup>  |
| Output Terminal Cross Section                  | 0.50-1.50 mm <sup>2</sup>  |
| Cable Capacity Cold Output Wires - Earth (Max) | 200 pF   |
| Cable Capacity Hot Output Wires - Earth (Max)  | 200 pF   |

### System characteristics

|                          |        |
|--------------------------|--------|
| Rated Ballast-Lamp Power | 36 W   |
| Rated Lamp Power on TL-D | 36 W   |
| System Power on TL-D     | 38.8 W |
| Lamp Power on TL-D       | 35 W   |
| Power Loss on TL-D       | 3.8 W  |

### Temperature

|                       |        |
|-----------------------|--------|
| T-Ambient (Max)       | 55 °C  |
| T-Ambient (Min)       | -20 °C |
| T-Storage (Max)       | 80 °C  |
| T-Storage (Min)       | -40 °C |
| T-Case Lifetime (Nom) | 75 °C  |
| T-Case Maximum (Max)  | 75 °C  |

### Mechanical and Housing

|         |             |
|---------|-------------|
| Housing | L 280x30x28 |
|---------|-------------|

### Emergency Operation

|                                       |              |
|---------------------------------------|--------------|
| Nominal Light Output After 60 Seconds | 100% of EBLF |
|---------------------------------------|--------------|

|   |             |
|---|-------------|
| Normal Operating Voltage (DC)               | 220-240 V   |
| Battery Voltage Guaranteed Operation        | 176-275 V   |
| Battery Voltage Guaranteed Ignition         | 186-275 V   |
| Emergency Ballast Lumen Factor (EBLF) (Nom) | 100 %       |
| Nominal Light Output After 5 Seconds        | 50% of EBLF |

### Approval and Application

|                         |   |
|-------------------------|---|
| Energy Efficiency Index | A2 BAT  |
| IP Classification       | IP 20 [ Ingress Protection 20]  |
| EMI 9 kHz ... 30 MHz    | EN55015   |
| Vibration Standard      | IEC68-2-6 F c   |
| Bumps Standard          | IEC 68-2-29 Eb (10G/16ms)   |
| Approval Marks          | F-Marking CE marking ENEC certificate CCC certificate C-Tick certificate PSB certification TISI marking SIRIM approval CB Certificate CCC certificate VDE-EMV certificate |
| Hum And Noise Level     | < 30 dB(A)  |

### Product Data

|                                 |                                       |
|---------------------------------|---------------------------------------|
| Full product code               | 87279009051900                        |
| Order product name              | HF-S 118/136 TL-D II 220-240V 50/60Hz |
| EAN/UPC - Product               | 8711500999290                         |
| Order code                      | 913713032166                          |
| Numerator - Quantity Per Pack   | 1                                     |
| Numerator - Packs per outer box | 12                                    |
| Material Nr. (12NC)             | 913713032166                          |
| Net Weight (Piece)              | 0.200 kg                              |

## Dimensional drawing

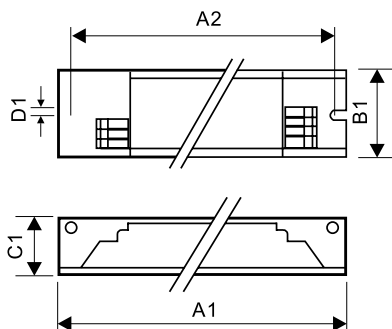

HF-S 136 TL-D II 220-240V 50/60Hz

### Product

HF-S 118/136 TL-D II 220-240V 50/60Hz

## HF-Selectalume II for TL-D lamps

