



# HID-HighPower for SON/MH/HPL/HPI

## BSN 1000 L78-A2 230/240V 50Hz HP-257

Encapsulated ballasts for use with SON (T) (Plus), HPL, HPI and MH lamps with rated wattages of 1000 W and above

### Product data

General Information	
Application Code	L78-A2
Design	HP-257
Lamp Type	SON
Number Of Lamps	1 piece/unit
Operating and Electrical	
Input Voltage	230 V (default) or 240 V
Input Frequency	50 Hz
Input Voltage (Multi-Tab)	230/240
Power Factor 100% Load (Nom)	0.87
Mains Voltage Performance (AC)	-8%+6%
Mains Voltage Safety (AC)	-10%+10%
Input Current With PF Correction	5.40 A
Input Current Without PF Correction	10.30 A
Power Factor Without PF Compensation (Nom)	0.50
Power Losses (Nom)	54.0 W
Wiring	
Wire Striplength	7.0 mm
Ballast Contact Wire Cross Section	0.70-6.00 mm <sup>2</sup>

Connector Type	Screw
System characteristics	
Capacitor	100µF/250V
Rated Ballast-Lamp Power	1000 W
Recommended Ignitor	Series ignitor - SN 56 (913619669966) / SN 59 (913619659966)
Temperature	
T-Storage (Max)	80 °C
T-Storage (Min)	-25 °C
T-Winding (Max)	130 °C
Delta-T Normal Conditions	70 °C
Approval and Application	
Approval Marks	CE marking ENEC certificate
Product Data	
Full product code	871150006236900
Order product name	BSN 1000 L78-A2 230/240V 50Hz HP-257
EAN/UPC - Product	8711500996640

## HID-HighPower for SON/MH/HPL/HPI

Order code	913700217503
Numerator - Quantity Per Pack	1
Numerator - Packs per outer box	1
Material Nr. (12NC)	913700217503

Net Weight (Piece)	12.700 kg
--------------------	-----------

### Dimensional drawing

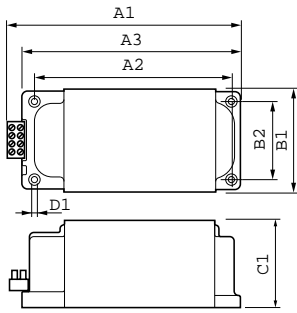

Product	D1	C1	A1	A2	A3	B1	B2
BSN 1000 L78-A2	6.5 mm	102.0	257.0	222.0	246.0	117.0	88.0
230/240V 50Hz		mm	mm	mm	mm	mm	mm
HP-257							

BSN 1000 L78 230/240V 50Hz HP-257

