

# Halogen non-reflector

DZA 6390 10.8V 30W 100PK

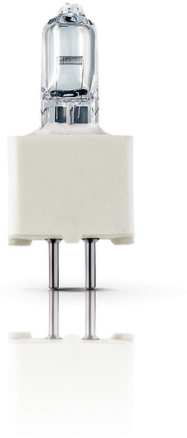

Halogen non-reflector lamps offer high-quality light and are easy to install, replace and operate. All halogen non-reflector lamps incorporate a distortion-free quartz bulb and a precise positioning of the mounted filament. These ensure optimal beam performance and consistent, high light output. A wide range of wattages is available for a broad variety of applications, including projection systems. In addition you get all the proven advantages of halogen technology such as a full spectrum and a color rendering index (CRI) of 100 – the same as natural light and the best that it can be. Halogen lamps also create a comfortable warm white light, and they maintain their lumen output, with almost no reduction, throughout their lifetime.

## Product data

### • General Information

Cap-Base	G5.3 [ G5.3]
Philips Code	6390
ANSI Code	DZA
LIF Code	-
Operating Position	Base Down +/- 90 D [ Base Down +/- 90 D]
Main Application	Projection
Life To 50% Failures (Nom)	1000 h

### • Light Technical

Luminous Flux (Rated) (Nom)	570 lm
Correlated Color Temperature (Nom)	3100 K
Color Rendering Index (Nom)	100

### • Operating and Electrical

Power (Rated) (Nom)	30 W
Voltage (Nom)	10.8 V

### • Mechanical and Housing

Bulb Material	Quartz-UV Open
Filament Shape	Flat
Filament Dimensions WxH	3.5x1.25

### • Luminaire Design Requirements

Bulb Temperature (Max)	900 °C
Pinch Temperature (Max)	400 °C

### • Product Data

Full product code	871150041008550
Order product name	6390 30W G5.3 10.8V 1CT/10X10F
EAN/UPC - Product	8711500410085
Order code	281170
Numerator - Quantity Per Pack	1
Numerator - Packs per outer box	100
Material Nr. (12NC)	822234361802
Net Weight (Piece)	0.007 kg

**PHILIPS**

# Halogen non-reflector

## Dimensional drawing

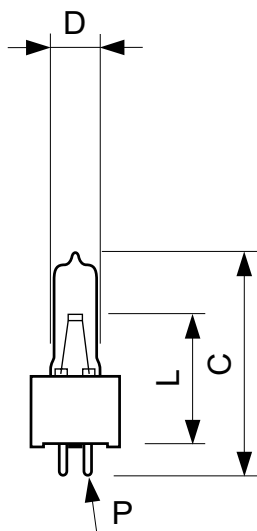

G5.3

### 6390 30W G5.3 10.8V

Product	D	L	L	L	P	P	P
6390 30W G5.3 10.8V 1CT/10X10F	9 mm	26.75 mm	27.25 mm	27 mm	1.55 mm	1.50 mm	1.45 mm

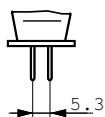

© 2015 Philips Lighting Holding B.V.  
All rights reserved.

Specifications are subject to change without notice. Trademarks are the property of Koninklijke Philips N.V. (Royal Philips) or their respective owners.

[www.philips.com/lighting](http://www.philips.com/lighting)

2015, December 23  
data subject to change