

BRITEARC SHORT ARC (BA SA)

BriteArc Short Arc Lamps are very compact high performance lamps, designed for the highest optical efficiency. These lamps can be operated in any position.

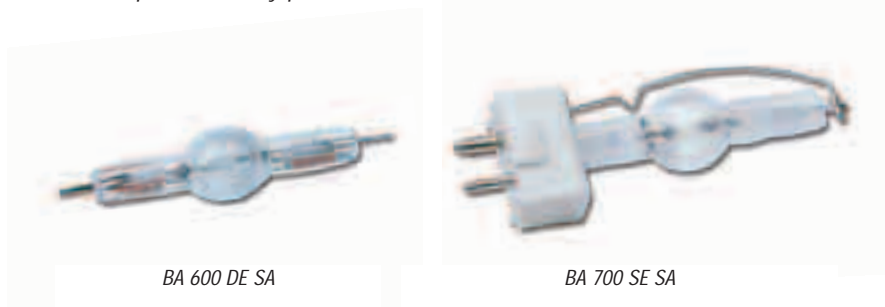

FEATURES

- Highest optical efficiency
- Low infrared
- Colour stability
- Excellent lumen maintenance
- Physical ruggedness

APPLICATIONS

- Show lighting
- Theatre
- Discotheque lighting
- Effect lighting
- Studio lighting

DIRECTIONS FOR USE

- Burning position: universal
- Only use in closed fixtures
- Can be operated on an electronic power supply or on a magnetic ballast

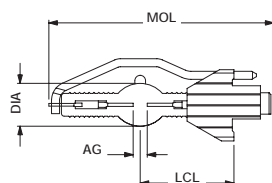

Fig. 1

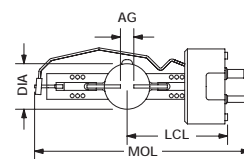

Fig. 2

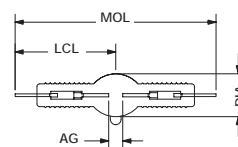

Fig. 3

Item description	Watt W	Voltage V	Current A	Ignition Pulse kV	Average Life hrs	Replacement Time hrs	Luminous Flux lm	Colour Temp. K	CRI	Total UV-output W
BA 600 SE SA (*)	600	95	6.3	3	300	350	48000	5300	90	50
BA 700 SE SA	700	70	11.0	2.5	500	700	50000	6600	75	80
BA 600 DE SA (*)	600	95	7.0	3	300	350	48000	5300	90	50

Item description	Cap	Dimensions				Max. bulb Temp. C°	Max. pinch Temp. C°	Figure Nr.	Packing Quantity	Ordering Code
		MOL mm	AG mm	Dia mm	LCL mm					
BA 600 SE SA (*)	FaX1.5	84	5	16	35	900	350	1	10	0023965
BA 700 SE SA	GY9.5	85	4	17	39	1000	450	2	10	0024003
BA 600 DE SA (*)	Mo pins	75	5	16		900	350	3	10	0023966

* Can be re-struck any time with a voltage peak of 25 kV. Nominal values measured at rated wattage in horizontal position.