



HID-PrimaVision Compact Independent for CDM

HID-PV C 2x35 /I CDM 220-240V SOFT START

Compact, lightweight and easy to use high performance range of electronic gears for optimal performance of 35W, 70W, 100W and 150W CDM lamps

Product data

• General Characteristics

Rated Number of Lamps	2 piece
Rated Ballast-Lamp Power	35
Rated Lamptype	CDM
Application code	-
Line Voltage	220-240 V
Line Frequency	50/60 Hz
Design	SOFT START
Housing	/I
Suitable for Outdoor use?	No

• Operating Characteristics

Automatic restart	Yes
Constant wattage deviation	-3%/+3%
Inrush current Peak	33 (max) A
Inrush current Width	1.85 ms
Max ballast on MCB(16A type B)	20 x
Earth leakage current (AC)	0.5 (max) mA
Mains voltage safety performance (AC)	-10%/+10%
Mains voltage performance (AC)	-8%/+6%
Operating frequency *	0.13 kHz
Overvoltage protection 320Vac	48 hr
PowerFactor 100% output power	0.95 -
Power losses gear	8 W
Ignition switch-off time	20 min

Ignition Voltage	4.5 (max) kV
Hum and Noise level	Inaudible

• Wiring Characteristics

Cable-Cap output-wires mutual	100 pF
Connector type	Insert
Max. cable length Device/Lamp	1.5 m
Wcs Ballast contacts	0.50-2.50 mm ²

• Temperature Characteristics

Active temperature protection	Yes
F-marking	Yes
T-case life	75 C
T-case maximum	80 (max) C
T-ambient	-20 (min), 55 (max) C
T-storage	-25 (min), 80 (max) C

• Approval & Application Chars

EMI 9 kHz ... 300MHz	CISPR 15 ed 7.2
Vibrations	IEC 68-2-6 Fc
Bumps	IEC 68-2-29 Eb
CE marking	Yes
ENEC certificate	Yes
VDE certificate	No
VDE-EMV certificate	No
CB Certificate	Yes

• Product Dimensions



asimpleswitch.com

PHILIPS

sense and simplicity

HID-PrimaVision Compact Independent for CDM

• Product Data

Order code 913700656466
 Full product code 913700656466
 Full product name HID-PV C 2x35 // I CDM 220-240V
 SOFT START
 Order product name HID-PV C 2x35 // I CDM 220-240V
 SOFT START
 Pieces per pack 1
 Packing configuration 6

Packs per outerbox 6
 Bar code on pack - EAN1 8711500881854
 Bar code on outerbox - EAN3 8727900897043
 Logistic code(s) - 12NC 913700656466
 Net weight per piece 0.625 kg

Dimensional drawing

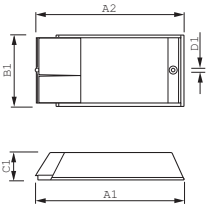

Product	A1 (Norm)	A2 (Norm)	A3 (Norm)	A4 (Norm)	B1 (Norm)	B2 (Norm)	B3 (Norm)	C1 (Norm)	D1 (Norm)
HID-PV C 2x35 // I CDM 220-240V SOFT START	-	-	-	-	-	-	-	-	-

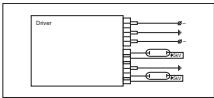

© 2011 Koninklijke Philips Electronics N.V.
 All rights reserved.

Specifications are subject to change without notice. Trademarks are the property of Koninklijke Philips Electronics N.V. or their respective owners.

www.philips.com/lighting

2011, June 7
 data subject to change