



HID-DynaVision 1-10V for SON/CDO

HID-DV 1-10V 150 /S CDO 220-240V 50/60Hz

Dimmable Electronic driver for SON/CDO lamps

Product data

• General Characteristics

Interface	1-10V
Rated Number of Lamps	1 piece
Rated Ballast-Lamp Power	150
Rated Lamptype	CDO
Line Voltage	220-240 V
Line Current	0.35 A
Line Frequency	50/60 Hz
Housing	/S
IP Classification	34
Luminaires	
Lifetime 90% surv.@Tcaselife	50000 hr
Suitable for Outdoor use?	Yes

• Operating Characteristics

Automatic restart	Yes
Control input protection	No
Inrush current Peak	50 (max) A
Inrush current Width	0.50 ms
Max ballast on MCB(16A type B)	8 x
Lamp Power Tolerance	-3%/+3%
Earth leakage current	0.5 (max) mA
Mains voltage safety (AC)	-10%/+10%
Mains voltage performance (AC)	-8%/+6%
Min. Mains voltage operational	180 (min) V
Output peak voltage	4000 (max) V

Operating frequency *	0.13 kHz
Overvoltage protection 320Vac	48 hr
Overvoltage protection 350Vac	2 hr
Overvoltage protection 400Vac	5 min
PowerFactor 100% output power	0.95 -
Regulating level power	60%-100%
Fade Rate Down	0.833 s
Fade Rate Up	50 s
Run-Up Time before Dimming	5 min
Ignition switch-off time	20 min
Ignition Voltage	3 (min), 4 (max) kV
Hum and Noise level	37 dB(A)

• System Chars on driver level

Rated Lamp Power on CDO	150
System Power on CDO	164.0
Lamp Power on CDO	147.0
Power Loss on CDO	17.0

• Wiring Characteristics

Cable-Cap output-wires mutual Connector type	120 pF Insert
--	------------------

PHILIPS

sense and simplicity

HID-DynaVision 1-10V for SON/CDO

Max. cable length	2 m
Device/Lamp	
Striplength	6.0 mm
Wcs Ballast contacts	0.50-2.50 mm2

CB Certificate Yes

• Temperature Characteristics

Active temperature protection	Yes
F-marking	Yes
T-case life	90 C
T-case switch-off	100 (min) C
T-ambient	-20 (min), 45 (max) C
T-storage	-25 (min), 80 (max) C

• Approval & Application Chars

EMI 30 MHz .. 1000MHz	CISPR 22 level B
Safety Standard	EN 60928, 60926
Quality Standard	ISO 9000:2000
Environmental Standard	ISO 14001
Harmonic current emissions	IEC 61000-3-2
Vibrations	IEC 68-2-6 Fc (10-150Hz, 2G)
Bumps	IEC 68-2-29 Eb (10G/16ms)
Humidity	IEC 928-13
Approval marks	KEMA / VDE / VDE-EMV
CE marking	Yes
ENEC certificate	No
VDE certificate	Yes
VDE-EMV certificate	Yes
Surge Protection	EN61547 (L-L 2kV, L-G 4kV)

• Product Dimensions

Length A1	150.0 mm
Fixing Hole Distance	134.0 mm
Length A2	
Length A3	136.0 mm
Width B1	90.0 mm
Fixing Hole Distance	70.0 mm
Width B2	
Height C1	40.0 mm
Fixing Hole Diameter	4.5 mm
D1	

• Product Data

Order code	913700657166
Full product code	913700657166
Full product name	HID-DV 1-10V 150 /S CDO 220-240V 50/60Hz
Order product name	HID-DV 1-10V 150 /S CDO 220-240V 50/60Hz
Pieces per pack	1
Packing configuration	10
Packs per outerbox	10
Bar code on pack - EAN1	8711500881922
Bar code on outerbox - EAN3	8727900888355
Logistic code(s) - 12NC	913700657166
Net weight per piece	0.725 kg

Dimensional drawing

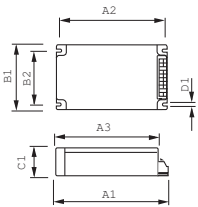

Product	A1 (Norm)	A2 (Norm)	A3 (Norm)	B1 (Norm)	B2 (Norm)	C1 (Norm)	D1 (Norm)
HID-DV 1-10V 150 /S CDO 220-240V 50/60Hz	150.0	134.0	136.0	90.0	70.0	40.0	4.5

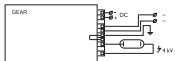

© 2011 Koninklijke Philips Electronics N.V.
All rights reserved.

Specifications are subject to change without notice. Trademarks are the property of Koninklijke Philips Electronics N.V. or their respective owners.

www.philips.com/lighting

2011, May 10
data subject to change