



# HF-Regulator II Touch and Dali for TL5 lamps

HF-Regulator TD 314 TL5 EII 220-240V 50/60Hz

Flat, lightweight high-frequency electronic regulating ballast, using DALI (Digital Addressable Lighting Interface) or Touch and Dim pushbutton protocol for TL5 fluorescent lamps

## Product data

### • General Characteristics

Interface	TD
Rated Number of Lamps	3 piece
Rated Ballast-Lamp Power	14
Rated Lamptype	TL5
Application code	EII
Line Voltage	220-240 V
Line Frequency	50-60 Hz
Housing	L 359x39x22
Ignition Method	Warm Start
Lifetime 90% surv.@Tcaselife	50000 hr
Energy Efficiency Index	A1

### • Operating Characteristics

Battery voltage running lamps	154-276
Battery voltage lamp ignition	196 V
Control input protection	Yes
Inrush current Peak	27 (max) A
Inrush current Width	0.25 ms
Earth leakage current	0.5 (max) mA
Mains voltage safety (AC)	-10%/+10%
Mains voltage performance (AC)	-8%/+6%
Overvoltage protection 320Vac	48 hr
Overvoltage protection 350Vac	2 hr
Power losses gear	7.7 W

Regulating level power	1%-100%
Stable lamp operation temp.	- [Not specified]
Standby power consumption	0.35 (max) W
Ballast Lumen Factor	1.0 -
Crestfactor	1.7 (max) -
Ignition time	0.2 (max) s
Operating frequency	85 (max) kHz
Total Harmonic Distortion EUR	10 %
Hum and Noise level	Inaudible

### • Wiring Characteristics

Conn.type input terminals	WAGO 251 universal connector [Suitable for both automatic wiring (ALF and ADS) and manual wiring]
Conn.type output terminals	WAGO 251 universal connector [Suitable for both automatic wiring (ALF and ADS) and manual wiring]
Conn.type ctrl input terminals	WAGO 251 universal connector [Suitable for both automatic wiring (ALF and ADS) and manual wiring]
Striplength	8.0-9.0 mm
Dual fixture Master/Slave	- [not specified]
Wcs Control input terminals	0.50-1.00 mm2
Wcs Input terminals	0.50-1.00 mm2
Wcs Output terminals	0.50-1.00 mm2
Wcs auto insertion (ALF/ADS)	0.5 mm2

# PHILIPS

sense and simplicity

# HF-Regulator II Touch and Dali for TL5 lamps

## • Temperature Characteristics

T-ignition	0 (min), 50 (max) C
T-ambient	-20 (min), 50 (max) C
T-storage	-25 (min), 80 (max) C

## • Approval & Application Chars

EMI 9kHz .. 30 MHz	EN 55015
EMI 30 MHz .. 1000MHz	EN 55022 level B [Level = Class]
Safety Standard	IEC 61347-2-3
Performance Standard	IEC 60929
Quality Standard	ISO 9000:2000
Environmental Standard	ISO 14001
Harmonic current emissions	IEC 61000-3-2
EMC Immunity	IEC 61547
Vibrations	IEC 68-2-6 Fc
Bumps	IEC 68-2-29 Eb
Humidity	EN 61347-2-3 clause 11
Approval marks	ENEC / VDE-EMV
CE marking	Yes
Temperature marking	110 [Yes]
Emergency standard	IEC 60598-2-22

## • Product Dimensions

Length A1	359 mm
Fixing Hole Distance	350 mm
Length A2	
Width B1	39 mm
Height C1	22 mm
Fixing Hole Diameter D1	4.2 mm

## • Product Data

Order code	913700629166
Full product code	913700629166
Full product name	HF-R TD 314 TL5 EII 220-240V 50/60Hz
Order product name	HF-R TD 314 TL5 EII 220-240V 50/60Hz
Pieces per pack	1
Packing configuration	10
Packs per outerbox	10
Bar code on pack - EAN1	8711500913517
Bar code on outerbox - EAN3	8711500913524
Logistic code(s) - 12NC	913700629166
Net weight per piece	0.340 kg

## Dimensional drawing

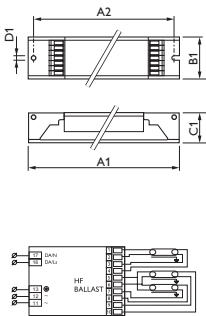

Product	A1 (Norm)	A2 (Norm)	B1 (Norm)	C1 (Norm)	D1 (Norm)
HF-R TD 314 TL5 EII 220-240V 50-60Hz	359	350	39	22	4.2



© 2011 Koninklijke Philips Electronics N.V.  
All rights reserved.

Specifications are subject to change without notice. Trademarks are the property of Koninklijke Philips Electronics N.V. or their respective owners.

[www.philips.com/lighting](http://www.philips.com/lighting)

2011, May 10  
data subject to change