

HF-Regulator II Touch and Dali for PL-T, PL-C and PL-R lamps

HF-Regulator TD 2 26-42 PL-T/C EII 220-240V

Flat, lightweight high-frequency electronic regulating control gear, using DALI (Digital Addressable Lighting Interface) or Touch and Dim push button protocol, for PL-T/C/R fluorescent lamps. The HF-REGULATORII ballasts incorporates the new Philips EII technology offering full digital input (mains) and output (lamp) management.

Product data

• General Characteristics

Interface	TD
Rated Number of Lamps	2 piece
Rated Ballast-Lamp Power	26-42
Rated Lamptype	PL-T/C
Application code	EII
Line Voltage	220-240 V
Line Frequency	50/60 Hz
Housing	S 123x79x33
Ignition Method	Warm Start
Lifetime 90% surv.@Tcaselife	50000 hr
Energy Efficiency Index	A1

Overvoltage protection 350Vac	2 hr
Power losses gear	6.0-7.5 W
Regulating level	1%-100%
Stable lamp operation temp.	- [Not specified]
Standby power consumption	0.35 (max) W
Ballast Lumen Factor	0.99 -
Crestfactor	1.7 (max) -
Ignition time	0.2 (max) s
Operating frequency	101 (max) kHz
Total Harmonic Distortion EUR	10 %
Hum and Noise level	Inaudible

• Operating Characteristics

Battery voltage running lamps	154-276
Battery voltage lamp ignition	196 V
Control input protection	Yes
Inrush current Peak	45 (max) A
Inrush current Width	0.35 ms
Max ballast on MCB(16A type B)	12 x
Earth leakage current	0.5 (max) mA
Mains voltage safety (AC)	-10%/+10%
Mains voltage performance (AC)	-8%/+6%
Overvoltage protection 320Vac	48 hr

• Wiring Characteristics

Conn.type input terminals	WAGO 251 universal connector [Suitable for both automatic wiring (ALF and ADS) and manual wiring]
Conn.type output terminals	WAGO 251 universal connector [Suitable for both automatic wiring (ALF and ADS) and manual wiring]
Conn.type ctrl input terminals	WAGO 251 universal connector [Suitable for both automatic wiring (ALF and ADS) and manual wiring]
Dual fixture Master/Slave	- [not specified]
Wcs Control input terminals	0.50-1.50 mm2
Wcs Input terminals	0.50-1.50 mm2
Wcs Output terminals	0.50-1.50 mm2
Wcs auto insertion (ALF/ADS)	0.5 mm2

HF-Regulator II Touch and Dali for PL-T, PL-C and PL-R lamps

• Temperature Characteristics

T-ignition	0 (min), 50 (max) C
T-ambient	-20 (min), 50 (max) C
T-storage	-20 (min), 80 (max) C

• Approval & Application Chars

EMI 9kHz .. 30 MHz	EN 55015
EMI 30 MHz .. 1000MHz	EN 55022 level B [Level = Class]
Safety Standard	IEC 61347-2-3
Performance Standard	IEC 60929
Quality Standard	ISO 9000:2000
Environmental Standard	ISO 14001
Harmonic current emissions	IEC 61000-3-2
EMC Immunity	IEC 61547
Vibrations	IEC 68-2-6 Fc
Bumps	IEC 68-2-29 Eb
Humidity	EN 61347-2-3 clause 11
Approval marks	ENEC / VDE-EMV
CE marking	Yes
Temperature marking	110 [Yes]
Emergency standard	IEC 60598-2-22

• Product Dimensions

Length A1	123 mm
Fixing Hole Distance	111 mm
Length A2	
Width B1	79 mm
Height C1	33 mm
Fixing Hole Diameter D1	4.5 mm

• Product Data

Order code	913700625782
Full product code	913700625782
Full product name	HF-R TD 2 26-42 PL-T/C EII 220-240V
Order product name	HF-R TD 2 26-42 PL-T/C EII 220-240V
Pieces per pack	1
Packing configuration	12
Packs per outerbox	12
Bar code on pack - EAN1	8711500913371
Bar code on outerbox - EAN3	8711500913388
Logistic code(s) - 12NC	913700625782
Net weight per piece	0.230 kg

Dimensional drawing

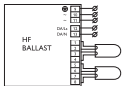
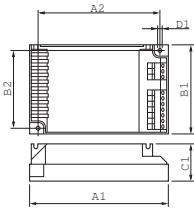

Product	A1 (Norm)	A2 (Norm)	B1 (Norm)	C1 (Norm)	D1 (Norm)
HF-R TD 226-42 PL-T/C EII	123	111	79	33	4.5



© 2011 Koninklijke Philips Electronics N.V.
All rights reserved.

Specifications are subject to change without notice. Trademarks are the property of Koninklijke Philips Electronics N.V. or their respective owners.

www.philips.com/lighting

2011, May 10
data subject to change