

HF-Regulator Touch&Dim/ Dali TL5 Circular

HF-R DALI 155 TL5C 220-240V 50/60Hz

Compact, lightweight High-Frequency electronic regulating ballast using DALI (Digital Addressable Lighting Interface) protocol for TL5C fluorescent lamps

Product data

• General Characteristics

Interface	DALI
Rated Number of Lamps	1 piece
Rated Ballast-Lamp Power	55
Rated Lamptype	TL5C
Line Voltage	220-240 V
Line Frequency	50/60 Hz
Housing	S 123x79x33
Ignition Method	Warm Start
Lifetime 90% surv.@Tcaselife	50000 hr
Energy Efficiency Index	A1

Overvoltage protection 320Vac	48 hr
Overvoltage protection 350Vac	2 hr
PowerFactor 100% output power	0.95 -
Power losses gear	6 W
Regulating level power	3%-100%
Stable lamp operation temp.	> 15°C
Standby power consumption	1.0 (max) W
Crestfactor	1.7 (max) -
Ignition time	2.0 (max) s
Operating frequency	100 (max) kHz
Hum and Noise level	Inaudible

• Operating Characteristics

Automatic restart	Yes
Battery voltage running lamps	176-254
Battery voltage lamp ignition	198-264 V
Constant wattage deviation	-2%/+2%
Control input protection	Yes
Inrush current Peak	19 (max) A
Inrush current Width	0.40 ms
Max ballast on MCB(16A type B)	12 x
Earth leakage current	0.5 (max) mA
Mains voltage safety (AC)	-10%/+10%
Mains voltage performance (AC)	-8%/+6%

• Wiring Characteristics

Cable-Cap output-wires to earth	75 pF
Cable-Cap output-wires mutual	30 pF
Conn.type input terminals	Insert
Conn.type output terminals	Insert
Conn.type ctrl input terminals	Insert
Striplength	7.5-8.5 mm
Dual fixture Master/Slave	Not applicable [Master/Slave oper. not applicable]
Wcs Control input terminals	0.50-1.50 mm ²
Wcs Input terminals	0.50-1.50 mm ²

PHILIPS

sense and simplicity

HF-Regulator Touch&Dim/Dali TL5 Circular

Wcs Output terminals 0.50-1.50 mm²

Emergency standard IEC 60598-2-22

• Temperature Characteristics

T-case life 65 C
 T-case maximum 75 (max) C
 T-ignition 10 (min), 50 (max) C
 T-ambient 10 (min), 50 (max) C
 T-storage -25 (min), 80 (max) C

• Approval & Application Chars

EMI 9kHz .. 30 MHz EN 55015
 EMI 30 MHz .. 1000MHz EN 55022 level B [Level = Class]
 Safety Standard IEC 61347-2-3
 Performance Standard IEC 60929
 Quality Standard ISO 9000:2000
 Environmental Standard ISO 14001
 Harmonic current emissions IEC 61000-3-2
 EMC Immunity IEC 61547
 Vibrations IEC 68-2-6 Fc
 Bumps IEC 68-2-29 Eb
 Humidity EN 61347-2-3 clause 11
 Approval marks ENEC / VDE-EMV
 CE marking Yes
 Temperature marking - [Not specified]

• Product Dimensions

Length A1 123.0 mm
 Fixing Hole Distance 111.0 mm
 Length A2
 Width B1 79.0 mm
 Fixing Hole Distance 67.0 mm
 Width B2
 Height C1 33.0 mm
 Fixing Hole Diameter 4.5 mm
 D1

• Product Data

Order code 913700600266
 Full product code 913700600266
 Full product name HF-R DALI 155 TL5C 220-240V 50/60Hz
 Order product name HF-R DALI 155 TL5C 220-240V 50/60Hz
 Pieces per pack 1
 Packing configuration 12
 Packs per outerbox 12
 Bar code on pack - EAN1 8711500934499
 Bar code on outerbox - EAN3 8711500934505
 Logistic code(s) - 12NC 913700600266
 Net weight per piece 0.200 kg

Dimensional drawing

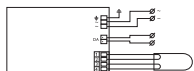
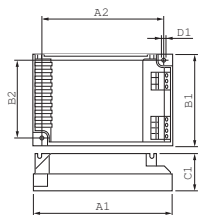

Product	A1 (Norm)	A2 (Norm)	B1 (Norm)	C1 (Norm)	D1 (Norm)
HF-R DALI 155 TL5C 220-240V 50/60Hz	123.0	111.0	79.0	33.0	4.5



© 2011 Koninklijke Philips Electronics N.V.
 All rights reserved.

Specifications are subject to change without notice. Trademarks are the property of Koninklijke Philips Electronics N.V. or their respective owners.

www.philips.com/lighting

2011, May 24
 data subject to change