



MASTERColour CDM-Tm Mini

MASTERColour CDM-Tm Mini 20W/830 PGJ5 KIT

Miniature, single-ended ceramic metal halide lamp PGJ5 twist-lock lamp base

Product data

• General Characteristics

Cap-Base	PGJ5
Bulb	T-3 1/2
Bulb Finish	Clear
Operating Position	any [Any or Universal (U)]
Life to 5% failures	9000 hr
Life to 10% failures	10000 hr
Life to 20% failures	11000 hr
Life to 50% failures	12000 hr

• Electrical Characteristics

System Power EL	24 W
Lamp Wattage	20 W
Lamp Wattage EL	22 W
Lamp Voltage	100 V
Lamp Current EL	0.220 A
Ignition Time	30 (max) s
Run-up time 90%	3 (max) min
Re-ignition Time [min]	15 (max) min
Dimmable	No

• Environmental Characteristics

Mercury (Hg) Content	2.4 mg
----------------------	--------

• Light Technical Characteristics

Color Code	830 [CCT of 3000K]
Color Rendering Index	82 (min), 85 (nom) Ra8
Color Designation (text)	Warm White
Color Temperature	3000 K

Color Temperature Technical	3020 K
Chromaticity Coordinate X	0.432 -
Chromaticity Coordinate Y	0.396 -
Luminous Flux Lamp EL	1650 Lm
Luminous Efficacy Lamp EL	75 Lm/W
Lumen Maintenance 2000h	75 %
Lumen Maintenance 5000h	65 %
Lumen Maintenance 10000h	60 %
Lumen Maintenance 1000h	80 %

• UV-related Characteristics

PET (NIOSH)	34 h.klx
Damage Factor D/fc	0.51 -

• Product Dimensions

Overall Length C	55 (max) mm
Diameter D	11.2 (max) mm
Light Center Length L	32 (min), 32.6 (nom), 33.1 (max) mm
Arc Length O	3 mm
Light Center Length L [inch]	1.28 in
Overall Length C [in]	2.5 (max) in
Diameter [inch]- D	0.44 in



asimpleswitch.com

PHILIPS

sense and simplicity

MASTERColour CDM-Tm Mini

• Luminaire Design Requirements

Cap-Base Temperature	250 (max) C
Bulb Temperature	380 (max) C

• Product Data

Order code	914499996230
Full product code	914499996230
Full product name	MASTERColour CDM-Tm Mini 20W/ 830 PGJ5 1SYS
Order product name	MMC LAMPKIT CDM-TM 20W/830

Pieces per pack	1
Packing configuration	12
Packs per outerbox	12
Bar code on pack - EAN1	8711500207661
Bar code on outerbox - EAN3	8711500207579
Logistic code(s) - 12NC	914499996230
ILCOS code	MC-20/30/1B-H-PGJ5
Net weight per piece	0.013 kg

Warnings and Safety

- Use only in totally enclosed luminaire, even during testing (IEC61167, IEC 62035, IEC60598)
- The luminaire must be able to contain hot lamp parts if the lamp ruptures
- Use only with electronic control gear
- Control gear must include end-of-life protection (IEC61167, IEC 62035)
- For 20W PGJ5 lamp, use only Philips electronic control gear HID PV mini PGJ5 22W
- For 35W PGJ5 lamp, use only Philips electronic control gear HID PV mini 35W

Dimensional drawing

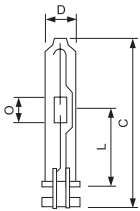

Product	C (Max)	D (Max)	L (Min)	L (Norm)	L (Max)	O (Min)	O (Norm)	O (Max)
CDM-Tm 20W/830 Lamp Kit	55	11.2	32	32.6	33.1	-	3	-

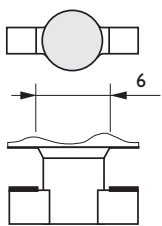

Photometric data

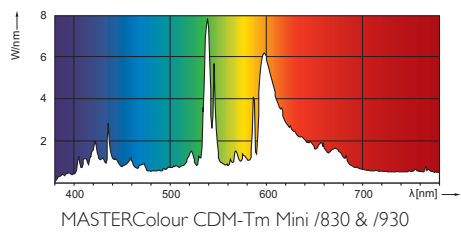

© 2011 Koninklijke Philips Electronics N.V.
All rights reserved.

Specifications are subject to change without notice. Trademarks are the property of Koninklijke Philips Electronics N.V. or their respective owners.

www.philips.com/lighting

2011, July 12
data subject to change