



# SceneSwitch LEDspot

## LEDspot50W GU10Kit\_S SSW 3step 50W CDL

Some situations call for cool light, others benefit from the ambiance of a warm cozy glow. With Philips SceneSwitch LEDspot, you can have different light settings from just one spot. And you don't need a dimmer! Optimize your lighting for relaxing, hobbies, recreation or working. Simply at the flick of a switch. And that's your existing switch! No extra installation is required.

### Product data

General information	
Cap-Base	GU10 [ GU10]
EU RoHS compliant	Yes
Nominal Lifetime (Nom)	15000 h
Switching Cycle	50000X
Light technical	
Color Code	865 [ CCT of 6500K]
Beam Angle (Nom)	36 °
Luminous Flux (Nom)	400-200-80 lm
Luminous Intensity (Nom)	600 cd
Color Designation	Cool Daylight
Correlated Color Temperature (Nom)	6500 K
Luminous Efficacy (rated) (Nom)	80.00 lm/W
Color Consistency	<6
Color Rendering Index (Nom)	80
LLMF At End Of Nominal Lifetime (Nom)	70 %
Operating and electrical	
Input Frequency	50 to 60 Hz
Power (Nom)	5 2 0.8 W
Wattage Equivalent	50 W

Starting Time (Nom)	0.5 s
Warm Up Time to 60% Light (Nom)	0.5 s
Power Factor (Nom)	0.4
Voltage (Nom)	100-240 V
Temperature	
T-Case Maximum (Nom)	80 °C
Controls and dimming	
Dimmable	No
Mechanical and housing	
Bulb Shape	PAR16 [ PAR 2 inch]
Approval and application	
Suitable For Accent Lighting	Yes
Product data	
Full product code	871951433273700
Order product name	LEDspot50W GU10Kit_S SSW 3step 50W CDL
EAN/UPC - Product	8719514332737
Order code	929002228341

# SceneSwitch LEDspot

Numerator - Quantity Per Pack	1
Numerator - Packs per outer box	6
Material Nr. (12NC)	929002228341

Net Weight (Piece)	0.060 kg
--------------------	----------

## Dimensional drawing

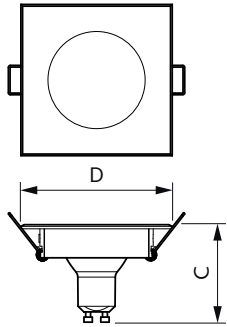

LEDspot50W GU10Kit\_S SSW 3step 50W CDL

Product	D	C
LEDspot50W GU10Kit_S SSW 3step 50W CDL	90 mm	61 mm

## Photometric data

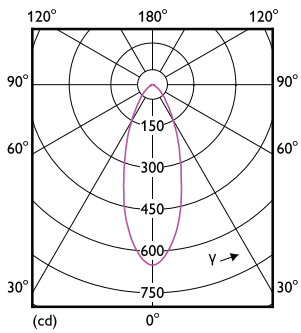

LEDspots K 50W PAR16 GU10 865 36D-LDD

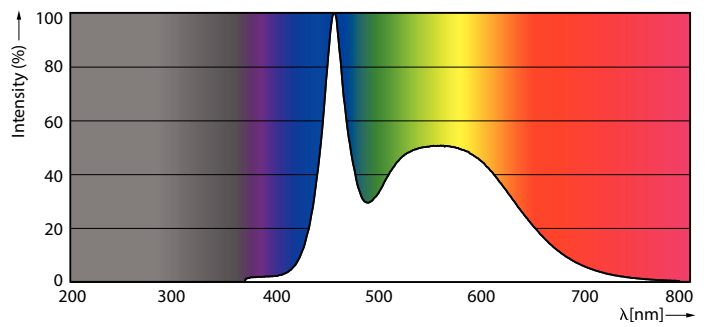

LEDspots K 50W PAR16 GU10 865 36D-POC

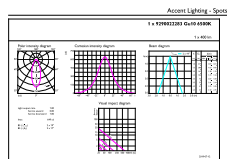

© 2021 Philips Lighting B.V. Page 11

LEDspots K 50W PAR16 GU10 865 36D 2-ADL

# SceneSwitch LEDspot

## Lifetime



Life Expectancy Diagram

Lumen Maintenance Diagram

