

MASTER TL5 Circular

MASTER TL5 Circular 22W/830 1CT



This circular TL5 lamp (tube diameter 16 mm) offers extended design possibilities. The slim tube allows the creation of extremely flat luminaires and enables omni-directional light distribution. It is suitable for a wide range of professional and semi-professional applications, and is ideal for use in shops, offices and public areas with unconventional layouts.

Product data

• General Characteristics

Cap-Base	2GX13
Bulb	C-T5 [C-T 16 mm]
Life to 10% fail	8000 hr
Preheat EL,3h	
Life to 50% fail	12000 hr
Preheat EL,3h	
LSF HF Preheat	99 %
2000h Rated,3h	
LSF HF Preheat	99 %
4000h Rated,3h	
LSF HF Preheat	96 %
6000h Rated,3h	
LSF HF Preheat	89 %
8000h Rated,3h	
LSF HF Preheat	50 %
12000h Rated,3h	
LSF HF Preheat	10 %
16000h Rated,3h	
LSF HF Preheat	1 %
20000h Rated,3h	

• Light Technical Characteristics

Color Code	830 [CCT of 3000K]
Color Rendering Index	80 (min), 85 (nom), 85 (max) Ra8
Color Designation (text)	Warm White
Color Temperature	3000 K
Luminous Flux EL 25°C, Rated	1800 Lm
Luminous Flux EL 25°C, Nominal	1800 Lm
Lum Efficacy Rated HF 25°C	82 Lm/W

LLMF HF 2000h Rated	91 %
LLMF HF 4000h Rated	87 %
LLMF HF 6000h Rated	84 %
LLMF HF 8000h Rated	81 %
LLMF HF 12000h Rated	77 %
LLMF HF 16000h Rated	74 %
LLMF HF 20000h Rated	72 %
Design Temperature	35 C
Chromaticity Coordinate X	440 -
Chromaticity Coordinate Y	403 -

• Electrical Characteristics

Lamp Wattage	22 W
Lamp Wattage EL 25°C, Rated	22.3 W
Lamp Wattage EL 25°C, Nominal	22 W
Lamp Voltage EL 25°C	75 V
Lamp Current EL 25°C	0.300 A
Dimmable	Yes

• Environmental Characteristics

Energy Efficiency Label (EEL)	A
-------------------------------	---

PHILIPS

MASTER TL5 Circular

Mercury (Hg) Content 2.5 mg
 Energy consumption 25 kWh
 kWh/1000h

• **Measuring Conditions**

Calibration Current 0.300 A
 HF Generator Rated Voltage 150 V
 Resistor 250 ohm

• **Product Dimensions**

Diameter D 14 (min), 18 (max) mm
 Overall Width E 220 (min), 230 (max) mm
 Inner Width I 187 (min), 197 (max) mm

• **Product Data**

Order code 927965083013
 Full product code 927965083013
 Full product name MASTER TL5 Circular 22W/830 1CT
 Order product name MASTER TL5 Circular 22W/830 1CT/10
 Pieces per pack 1
 Packing configuration 10
 Packs per outerbox 10
 Bar code on pack - EAN1 8711500640956
 Bar code on outerbox - EAN3 8711500640963
 Logistic code(s) - 12NC 927965083013
 ILCOS code FSCH-22/30/1B-L/P-2GX13-16
 Net weight per piece 45.000 gr

Dimensional drawing

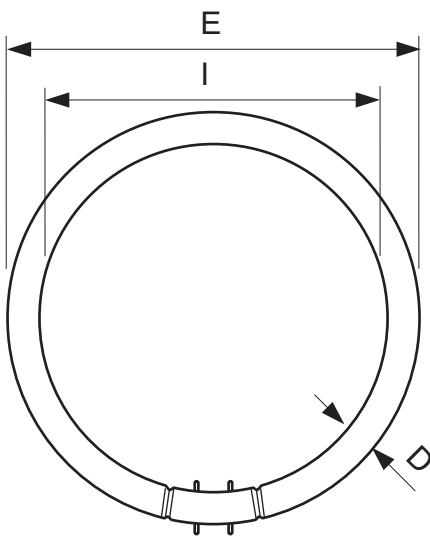

MASTER TL5 Circular 22W/830 1CT

Product	D (Min)	D (Max)	E (Min)	E (Max)	I (Min)	I (Max)
TL5-C 22W/830	14	18	220	230	187	197

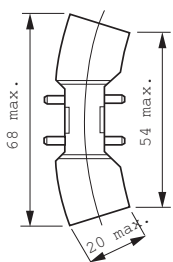

2GX13

Photometric data

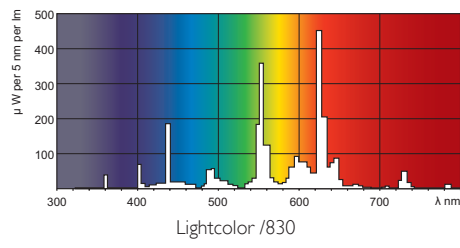
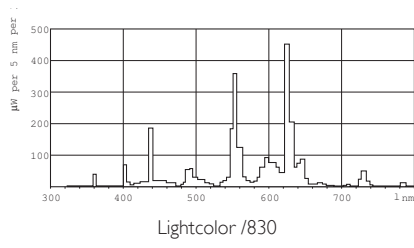

© 2014 Koninklijke Philips N.V. (Royal Philips)
All rights reserved.

Specifications are subject to change without notice. Trademarks are the property of Koninklijke Philips N.V. (Royal Philips) or their respective owners.

www.philips.com/lighting

2014, July 17
data subject to change