

HF-Matchbox Red

HF-M RED 118 SH PL-C/PL-T 230-240V

HF-Matchbox Red is an affordable, reliable, compact, lightweight and high-frequency ballast for use with system wattages below 25 W in combination with TL mini, TL-D, TL5 and TL5c, PL-T/C, and PL-L/S lamps. The HF-M Red range has a robust design, meets all relevant international safety and performance standards and has an energy efficiency index (CELMA EEI) of A2.

Product data

• General Characteristics

Rated Lamptype	PL-C/PL-T
Rated Number of Lamps	1 piece
Rated Ballast-Lamp Power	18
Line Voltage	230-240 V
Line Frequency	50/60 Hz
Housing	SH
Lifetime 90%	40000 hr
	serv.@Tcaselife

• Operating Characteristics

Automatic restart	Yes
Maximum ignition time	0.45 (max) s
Mains voltage safety (AC)	-10%/+10%
Mains voltage performance (AC)	-8%/+6%
Power losses gear	2.0-2.1 W
PowerFactor 100% output power	0.62 -
Battery voltage lamp ignition	194-254 V
Overvoltage protection 320Vac	0.03 hr
Max ballast on MCB(16A type B)	73 x

• Wiring Characteristics

Color input terminals	Orange
Color output terminals	Grey

Conn.type input terminals	Insert
Conn.type output terminals	Insert
Max. cable length Device/Lamp	1.50 m
Max. cable length Hot Wires	0.30 m
Striplength	8.0-9.0 mm
Wcs Input terminals	0.50-1.50 mm ²
Wcs Output terminals	0.50-1.50 mm ²

• System Chars on driver level

Rated Lamp Power on PL-T	18
System Power on PL-T	17.3
Power Loss on PL-T	2.1
Lamp Power on PL-T	15.2
System Power on PL-C	17.9
Rated Lamp Power on PL-C	18
Power Loss on PL-C	2
Lamp Power on PL-C	15.9

• Temperature Characteristics

F-marking	Yes
T-case maximum	75 (max) C
T-ambient	-10 (min), 40 (max) C

• Product Dimensions

Length A1	80.0 mm
-----------	---------

PHILIPS

HF-Matchbox Red

Fixing Hole Distance	70.0 mm
Length A2	
Width B1	40.0 mm
Height C1	22.0 mm
Fixing Hole Distance	10.0 mm
Height C2	
Fixing Hole Diameter	4.4 mm
D1	

• Approval & Application Chars

CE marking	Yes
ENEC certificate	Yes
VDE certificate	No
UL certificate	No
CB Certificate	Yes

• Product Data

Order code	913700423466
Full product code	913700423466
Full product name	HF-M RED 118 SH PL-C/PL-T 230-240V
Order product name	HF-M RED 118 SH PL-C/PL-T 230-240V
Pieces per pack	1
Packing configuration	50
Packs per outerbox	50
Bar code on pack - EAN1	8711500928023
Bar code on outerbox - EAN3	8711500928030
Logistic code(s) - 12NC	913700423466
Net weight per piece	0.034 kg

Dimensional drawing

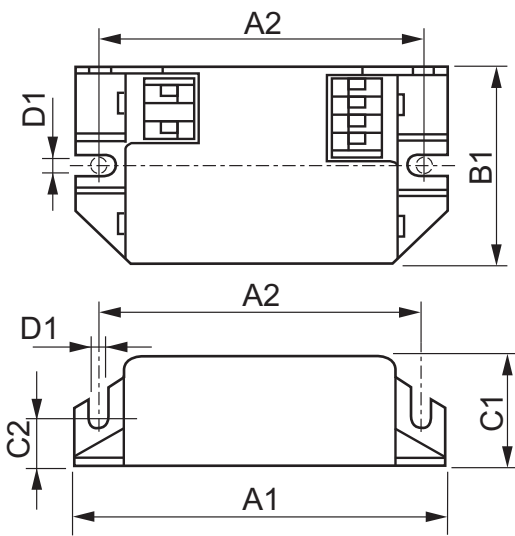

HF-M RED 118 SH PL-C/PL-T 230-240V

Product	A1 (Norm)	A2 (Norm)	B1 (Norm)	C1 (Norm)	C2 (Norm)	D1 (Norm)
HF-M RED 118 SH PL-C/PL-T 230-240V	80.0	70.0	40.0	22.0	10.0	4.4

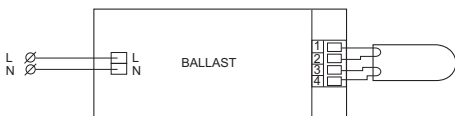

© 2014 Koninklijke Philips N.V. (Royal Philips)
All rights reserved.

Specifications are subject to change without notice. Trademarks are the property of Koninklijke Philips N.V. (Royal Philips) or their respective owners.

www.philips.com/lighting

2014, April 11
data subject to change