



# HF-Matchbox Blue

## HF-M BLUE 121 LH TL5 230-240V

HF-Matchbox Blue is an affordable, reliable, compact, lightweight and high-frequency ballast for use with system wattages below 25 W in combination with TL mini, TL-D, TL5 and TL5c, PL-T/C, and PL-L/S lamps. The HF-M Blue range has a robust design, meets all relevant international safety and performance standards and has an energy efficiency index (CELMA EEI ) of A2.

### Product data

#### • General Characteristics

Rated Lamptype	TL5
Rated Number of Lamps	1 piece
Rated Ballast-Lamp Power	21
Line Voltage	230-240 V
Line Frequency	50/60 Hz
Housing	LH

#### • Operating Characteristics

Automatic restart	Yes
Maximum ignition time	0.5 (max) s
Mains voltage safety (AC)	-10%/+10%
Mains voltage performance (AC)	-8%/+6%
Power losses gear	2.4 W
PowerFactor 100% output power	0.64 -
Battery voltage lamp ignition	194-254 V
Overvoltage protection 320Vac	0.03 hr
Max ballast on MCB(16A type B)	59 x

#### • Wiring Characteristics

Color input terminals	Grey
Color output terminals	Grey
Conn.type input terminals	Insert

Conn.type output terminals	Insert
Max. cable length Device/Lamp	1.50 m
Max. cable length Hot Wires	0.30 m
Striplength	8.0-9.0 mm
Wcs Input terminals	0.50-1.50 mm <sup>2</sup>
Wcs Output terminals	0.50-1.50 mm <sup>2</sup>

#### • Temperature Characteristics

F-marking	Yes
T-case maximum	75 (max) C
T-ambient	-10 (min), 40 (max) C

#### • Product Dimensions

Length A1	187.0 mm
Fixing Hole Distance	176.0 mm
Length A2	
Width B1	22.0 mm
Height C1	22.0 mm
Fixing Hole Diameter D1	4.4 mm

#### • Approval & Application Chars

CE marking	Yes
ENEC certificate	No
VDE certificate	Yes
UL certificate	No
CB Certificate	Yes

**PHILIPS**

# HF-Matchbox Blue

## • Product Data

Order code 913700418366  
Full product code 913700418366  
Full product name HF-M BLUE 121 LH TL5 230-240V  
Order product name HF-M BLUE 121 LH TL5 230-240V  
Pieces per pack 1  
Packing configuration 50  
Packs per outerbox 50

Bar code on pack - EAN1 8711500536464  
Bar code on outerbox - EAN3 8711500536471  
Logistic code(s) - 12NC 913700418366  
Net weight per piece 0.043 kg

## Dimensional drawing

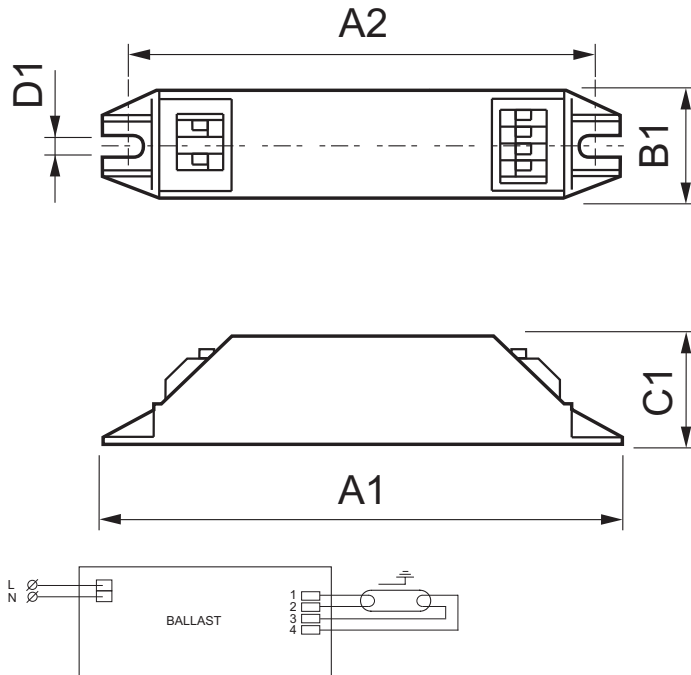

## HF-M BLUE 121 LH TL5 230-240V

Product	A1 (Norm)	A2 (Norm)	B1 (Norm)	C1 (Norm)	D1 (Norm)
HF-M BLUE 121 LH TL5 230-240V	187.0	176.0	22.0	22.0	4.4



© 2014 Koninklijke Philips N.V. (Royal Philips)  
All rights reserved.

Specifications are subject to change without notice. Trademarks are the property of Koninklijke Philips N.V. (Royal Philips) or their respective owners.

[www.philips.com/lighting](http://www.philips.com/lighting)

2014, April 11  
data subject to change