

PHILIPS

Lighting



HF-Performer II Xtreme for TL5/TL-D lamps

HF-P XT 254 TL5 EII 220-240V 50/60HZ

HF-Performer Xtreme is a unique X-technology from Philips that guarantees the highest lifetime reliability for lamps and enables an extra-long and reliable HF system life with an energy efficiency index (CELMA EEI) of A2.

Product data

General Information

Application code	EII
Type version	mk1
Lamp type	TL5
Number of lamps	2 piece/unit
Number of products on MCB (16 A type B) (nom.)	12
Automatic restart	Yes

Operating and Electrical

Input voltage	220 to 240 V
Input frequency	50 to 60 Hz
Operating frequency (min.)	42 kHz
Ignition method	Warm Start
Crest factor (max.)	1.7
Power factor 100% load (nom.)	0.96
Ignition time (max.)	2.0 s
Mains voltage performance (AC)	-8%+6%
Mains voltage safety (AC)	-10%+10%
Earth leakage current (nom.)	0.5 mA
Inrush current width	0.310 ms

Constant wattage deviation	-2%/+2%
Ballast factor (nom.)	1.00
Power losses (nom.)	9.5 W
Inrush current peak (max.)	33 A

Wiring

Connector type input terminals	WAGO 251 universal connector [Suitable for both automatic wiring (ALF and ADS) and manual wiring]
Cable capacity output wires mutual (nom.)	200 pF
Connector type output terminals	WAGO 251 universal connector [Suitable for both automatic wiring (ALF and ADS) and manual wiring]
Wire strip length	8.0-9.0 mm
Input terminal cross section	0.50-1.00 mm ²
Output terminal cross section	0.50-1.00 mm ²
Auto Insert (ALF/ADS) Wire Cross Section	0.5 mm ²
Cable capacity output wires to earth (nom.)	200 pF

HF-Performer II Xtreme for TL5/TL-D lamps

System characteristics	
Rated ballast-lamp power	54 W
Rated lamp power on TL5	54 W
System power on TL5	63.5 W
Lamp power on TL5	54 W
Power loss on TL5	9.5 W
Temperature	
T ambient (max.)	60 °C
T ambient (min.)	-25 °C
T storage (max.)	80 °C
T storage (min.)	-25 °C
T case lifetime (nom.)	75 °C
T-Case maximum (max.)	75 °C
T-ignition (max.)	60 °C
T-ignition (min.)	-25 °C
Mechanical and Housing	
Housing	L 360x30x28
Emergency Operation	
Battery voltage lamp ignition	198 V
Battery voltage lamp operation	176-254
Approval and Application	
Energy efficiency index	A2
EMI 9 kHz... 30 MHz	EN55015
EMI 30 MHz... 1,000 MHz	EN55022 level B

Safety standard	IEC 61347-2-3
Performance standard	IEC 60929
Quality standard	ISO 9000:2000
Environmental standard	ISO 14001
Harmonic current emission standard	IEC 61000-3-2
EMC immunity standard	IEC 61547
Vibration standard	IEC68-2-6 F c
Bumps standard	IEC 68-2-29 Eb
Humidity standard	EN 61347-2-3 clause 11
Approval marks	CE marking ENEC certificate VDE-EMV certificate
Temperature marking	Yes
Emergency standard	IEC 60598-2-22
Humming and noise level	Inaudible

Product Data

Full product code	871150091431630
Order product name	HF-P Xt 254 TL5 EII 220-240V 50/60Hz
EAN/UPC – product	8711500914316
Order code	91431630
Local Code	HFPXT254TL5EII
Numerator – quantity per pack	1
Numerator – packs per outer box	12
Material no. (12NC)	913700630066
Net weight (piece)	0.360 kg

Dimensional drawing

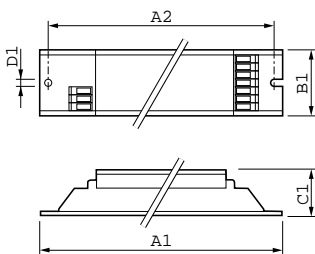

Product	D1	C1	A1	A2	B1
HF-P Xt 254 TL5 EII 220-240V 50/60Hz	4.2 mm	28.0 mm	360.0 mm	350.0 mm	30.0 mm

HF-P Xt 254 TL5 EII 220-240V 50/60Hz

HF-Performer II Xtreme for TL5/TL-D lamps

